

Date: 2023-06-21
 Enquiry dated:
 Project:
 Quotation-no.:
 Item:
 Reference:

Air cooler GGHF 040.2F/17-ANW50/30P.E For calculation only!

| | | | |
|-------------------------|------------------------|-----------------------|--|
| Capacity: | 4.9 kW ⁽¹⁾ | Medium: | Ethylene glycol 34 Vol. % ⁽²⁾ |
| Surface reserve: | 0.0 % | Inlet: | -5.0 °C |
| Air flow: | 3210 m ³ /h | Outlet: | 0.0 °C |
| Air inlet: | 8.0 °C | Pressure drop: | 0.71 bar |
| Air outlet: | 4.8 °C | Volume flow: | 0.91 m ³ /h |
| Air pressure: | 1013 mbar | | |

| | | | |
|---------------------------------------|--------------------------|------------------------------|----------------------------------|
| Fans: | 1 Piece(s) 1~230V 50Hz | Noise pressure level: | 52 dB(A) in 3.0 m ⁽³⁾ |
| Data per motor (nominal data): | | Noise power level: | 74 dB(A) |
| Speed: | 1390 min-1 | Air throw: | approx. 28 m ⁽⁴⁾ |
| Capacity (mech./el.): | 0.22 kW/0.23 kW | Frost: | 0.0 mm |
| Current: | 1.05 A ⁽⁵⁾ | | |
| ErP: | Compliant ⁽⁶⁾ | | |

| | | | |
|---------------------------------|------------------------------|------------------------------|-------------------------------|
| Casing: | AlMg, Powder coated RAL 9003 | Tubes: | Copper ⁽⁷⁾ |
| Surface: | 14.7 m ² | Fins: | Aluminum ⁽⁷⁾ |
| Tube volume: | 5.7 l | Connections per unit: | |
| Fin spacing: | 7.00 mm | Inlet: | 22.0 * 1.00 mm |
| Dry weight: | 39 kg ⁽⁸⁾ | Outlet: | 22.0 * 1.00 mm |
| Max. operating pressure: | 16.0 bar | PED classification: | Art. 3, par. 3 ⁽⁹⁾ |

Dimensions:

- L = 1090 mm
- B = 580 mm
- H = 550 mm
- E = 680 mm
- F = 425 mm
- C = 210 mm
- A = 400 mm
- ØD = 11 mm
- K = G1¼

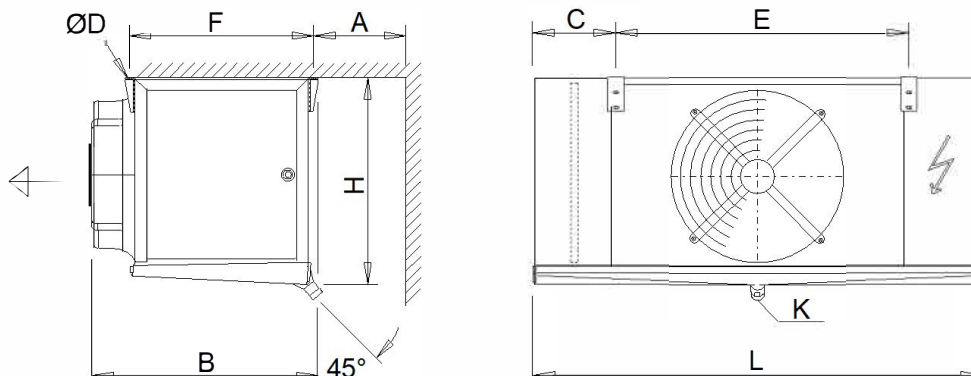

Drain according to DIN ISO 228-1 with G-thread (flat gasket).
 Attention: Drawing and dimensions not valid for all accessory options!

